

Note: mast and boom bands to be not less than 10 mm. in width. rule 16.1.7
The mast to be free from staying or bracing above a point 5166 mm from the heel, tenon excluded rule 14(a)

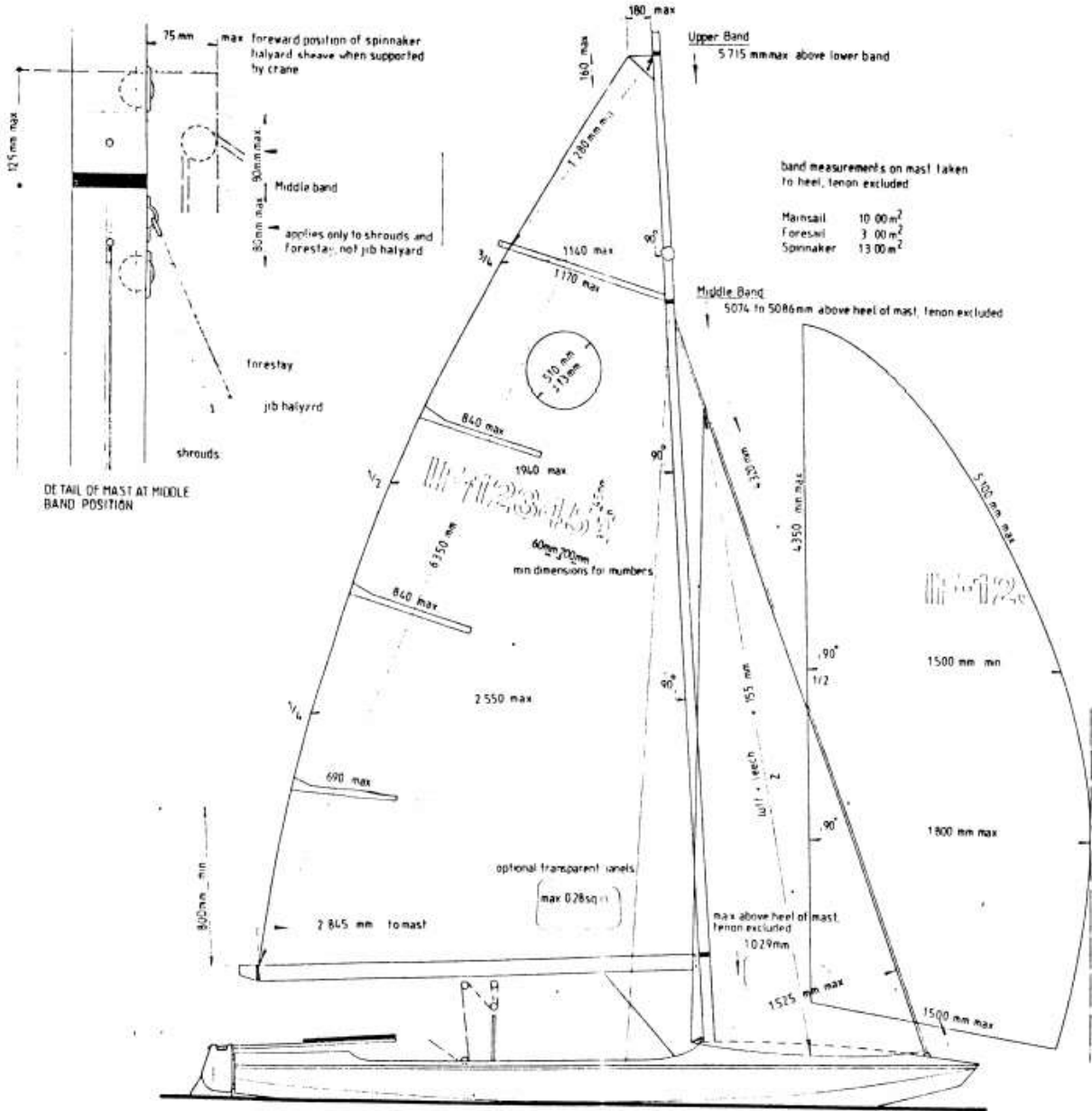

REFER TO THE CLASS RULES FOR THE REGULATIONS CONCERNING CONSTRUCTION AND REGISTRATION

SAILPLAN

Designed by Peter Mine
Drawn by David Redding
Published by Fireball International
Date: May 1986

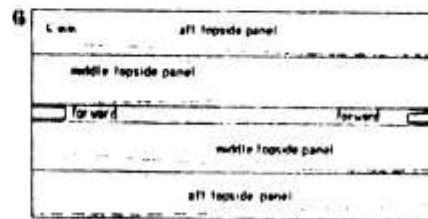
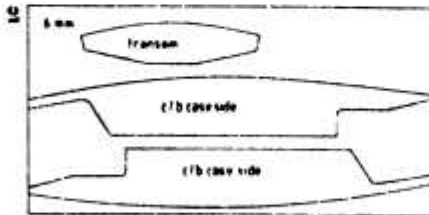
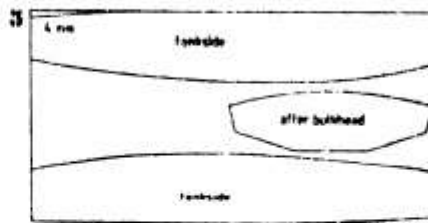
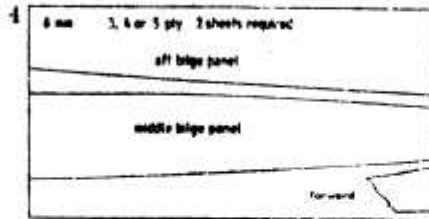

Note:
Topside and bottom panels to be marked out from offcuts after their respective parallel blanks are scarfed. Allow 30mm over nominal panel width for blank size.

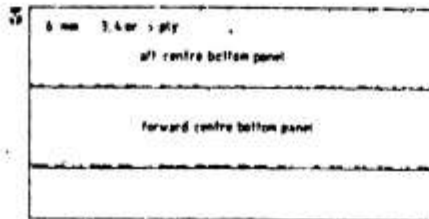

For bottom panel, see note

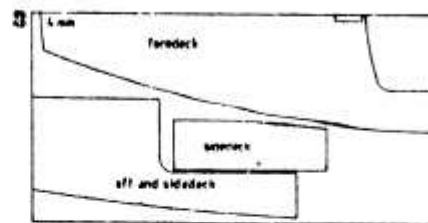
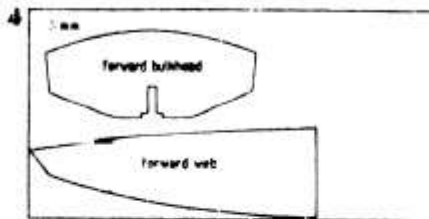
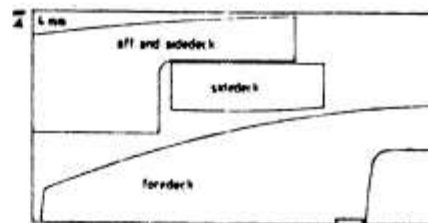

PLYWOOD LAYOUT SKETCH

This sketch shows the suggested layout of the various items on the sheets of Ply. Do Not Scale From This Drawing.

Designed by Prier Mine
Drawn by David Robbins
Published by Fireball International

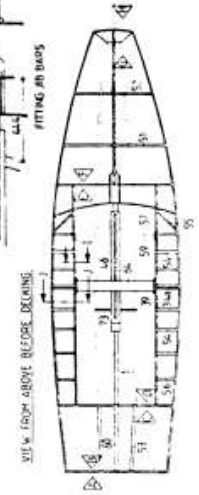
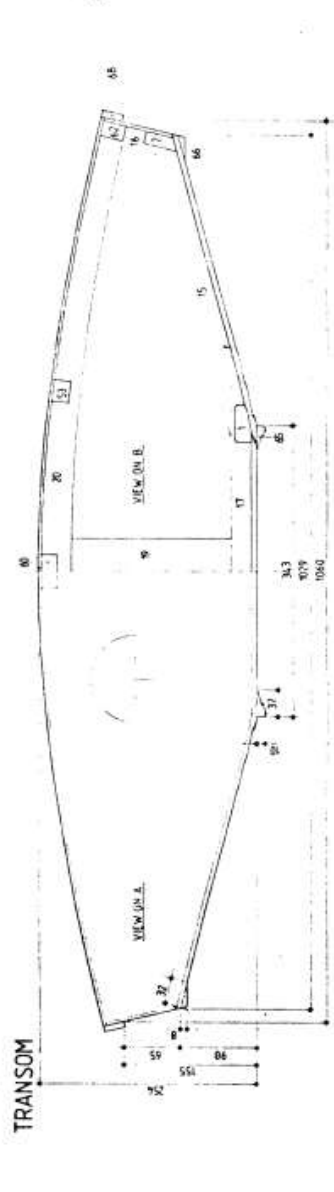
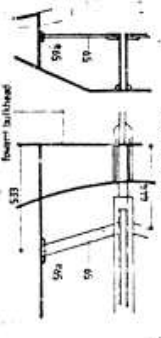
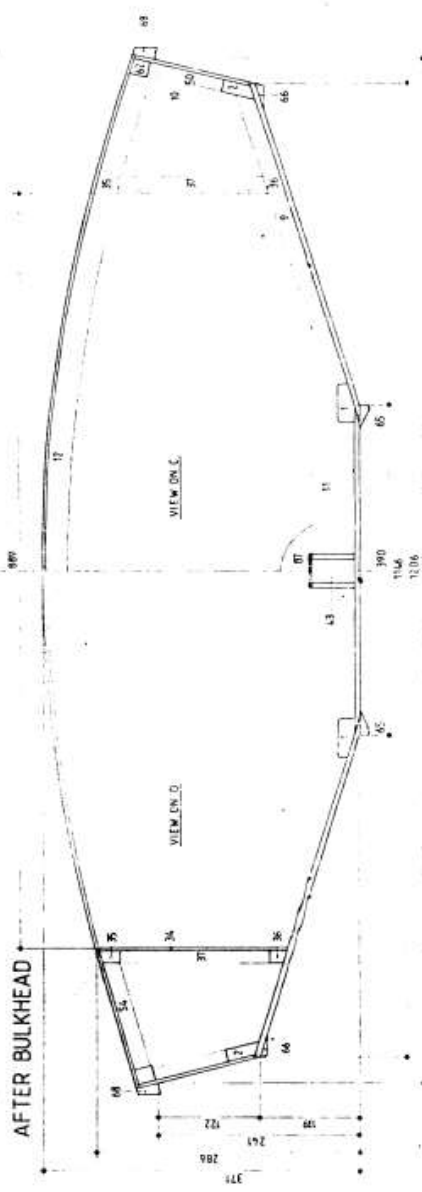
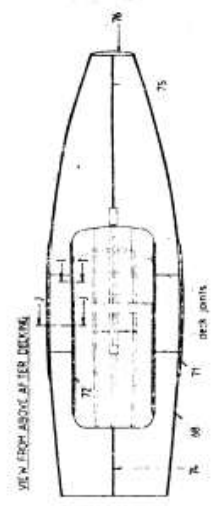
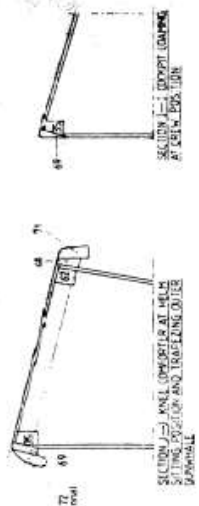
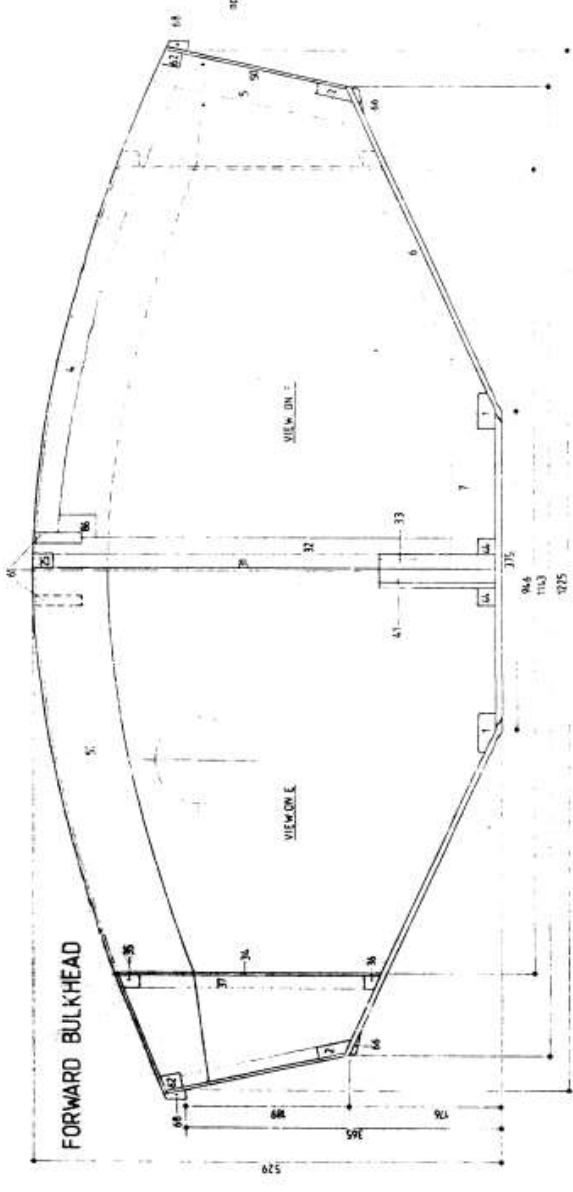

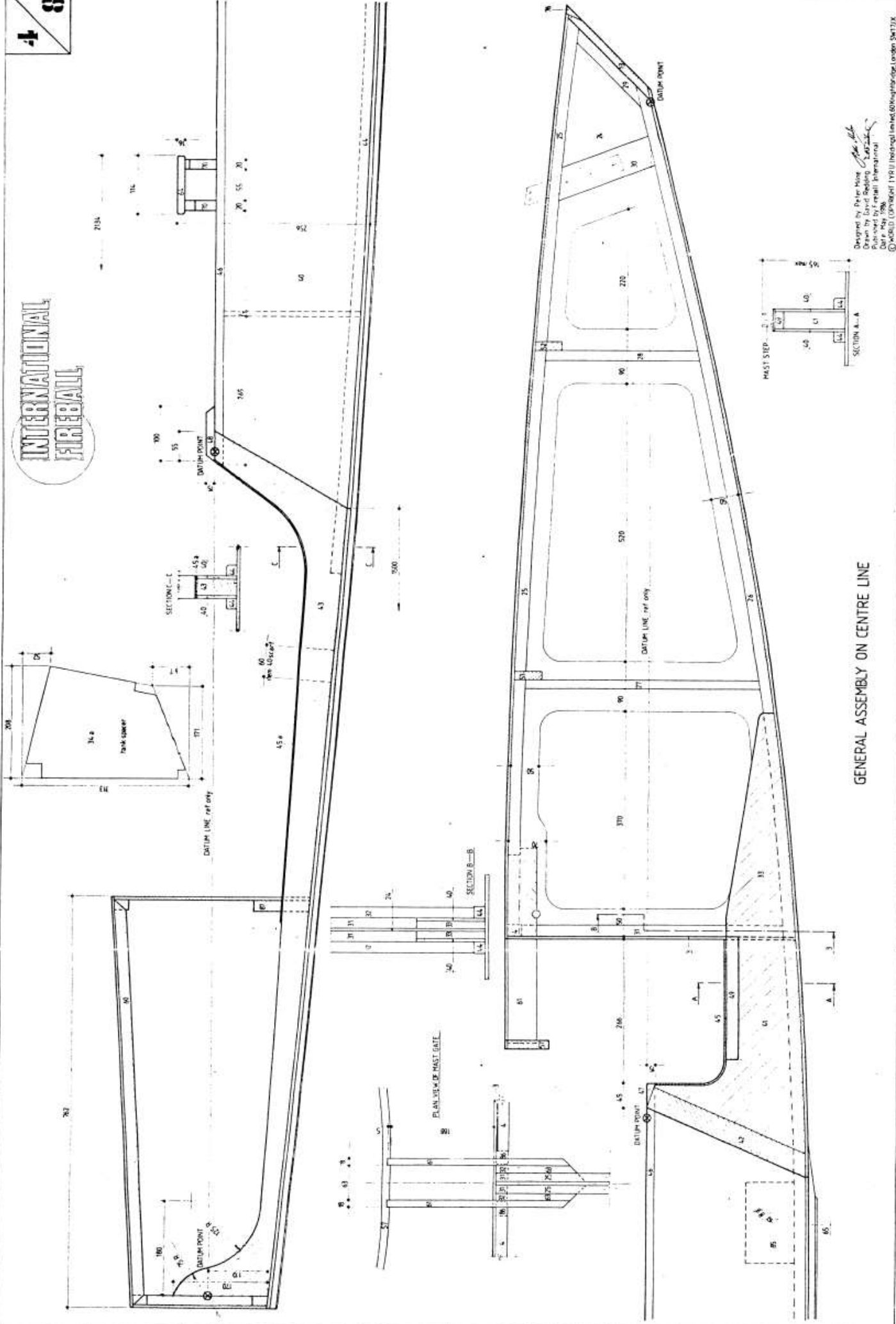
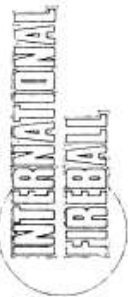

GENERAL ASSEMBLY ON CENTRE LINE

Designed by Peter Howe
 Drawn by David Beeking
 Published by Fireball International
 Date: May 1986
 © Fireball International 1986

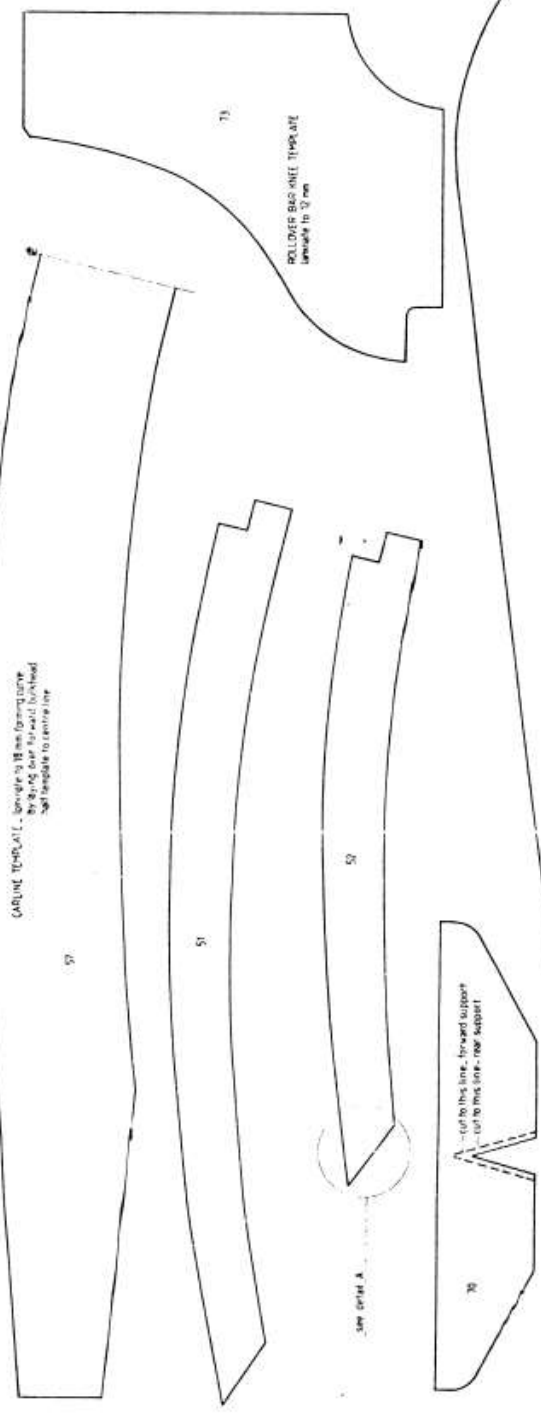

RUDER BLADE. Typical lifting rudder blade shape. Design optimum to be used with proprietary metal stock.

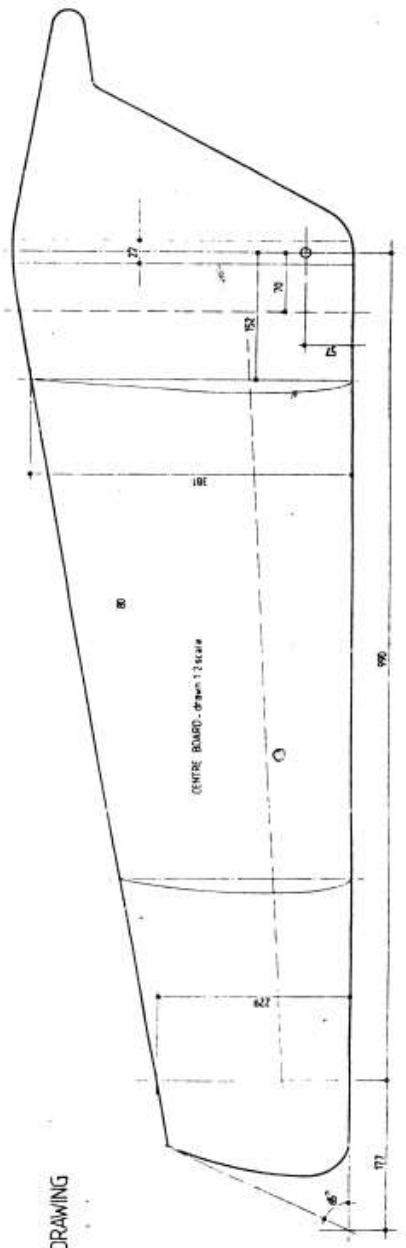
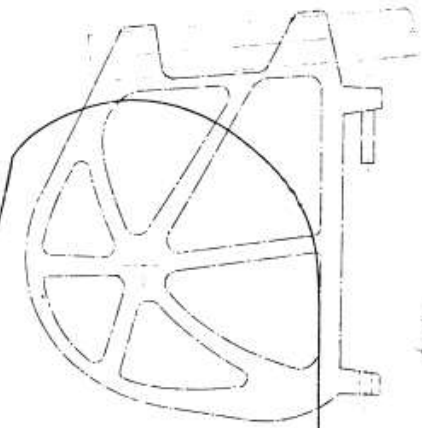

TEMPLATE DRAWING

Designed by Peter White
 Drawn by David Peckley
 © 1988 International Fireball
 All Rights Reserved

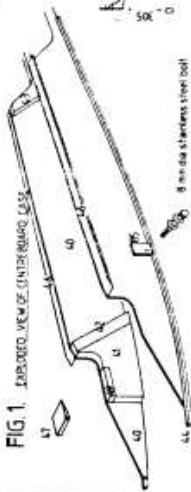

FIG. 1 EXPLODED VIEW OF CENTERBOARD CASE

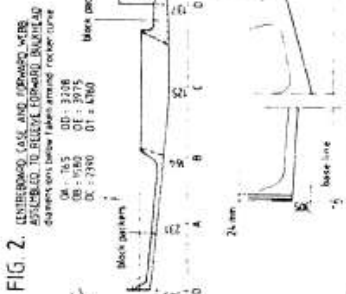

FIG. 2 CENTERBOARD CASE AND UPPERBOARD WERE ASSEMBLED TO RELEASE FORWARD BULKHEAD

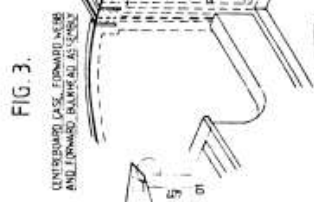

FIG. 3 CENTERBOARD CASE, FORWARD WERE AND LOWERBOARD WERE ASSEMBLED



FIG. 4 SCURING PROCEDURE

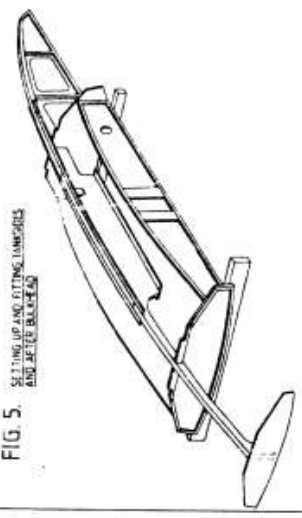

FIG. 5 SETTING UP AND FITTING LAMBSKINS AND AFTER BULKHEAD

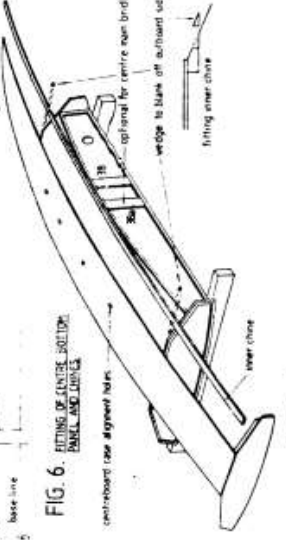

FIG. 6 FITTING OF CENTRE BOARD PANEL AND LOWERBOARD

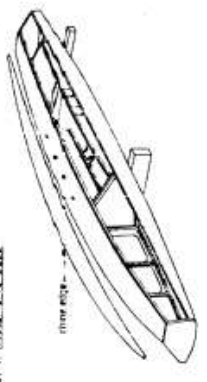

FIG. 7 HOALING ISSUES

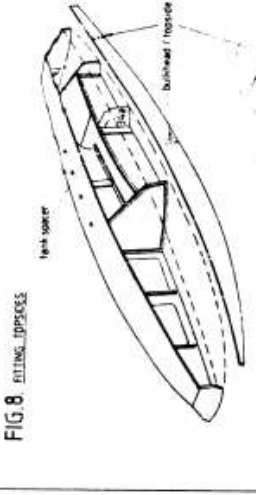

FIG. 8 FITTING UPPERBOARD



FIG. 9 HARD-CLIP AND FITTING BLUE PANEL

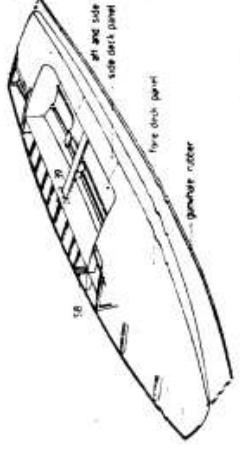

FIG. 11 DECKING

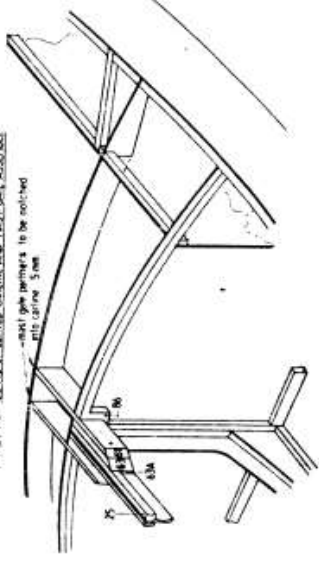

FIG. 10 DETAIL OF CURVED CARLINE AND MAST GATE ASSEMBLY

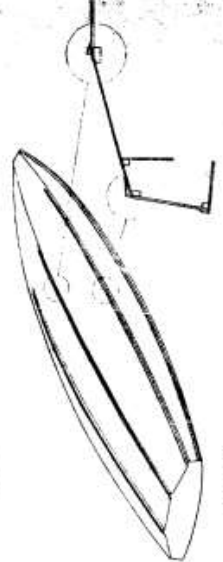

FIG. 12 FITTING BOTTOM BAILS AND COCK PIT DECKTOPS

FIREBALL BUILDING PROCEDURE SKETCHES

Designed by Peter Alton
 Drawn by David Hocking
 Published by Fireball International
 © 2000 (03/2000) 11/2000 (revised) 04/2000 (revised) 06/2001 (rev)